

Wireless Module

WIRELESS MODULE MATERIALS &

COMPONENTS:

- **Casing:** Polycarbonate, Steel (ball plunger)
- **Cap:** Thermoplastic elastomers (TPE), Steel (screws)
- **Circuit Board:** LED lights, FR4 Fiberglass
- **Batteries:** 1.5V alkaline AAA (Manganese Dioxide, Zinc, Potassium Hydroxide, Graphite)

MODULE BATTERY & POWER:

- **Supply Source:** Three AAA Batteries (each rated 1.5 V DC, Max 1200 mAh)
- **Supply Voltage:** 4.5 V DC
- **Operational Current Rating:** 30 mA
- **Life Expectancy:** 2 years (use and temperature dependent)

MODULE ENVIRONMENT:

- Intended for indoor and outdoor use
- Altitude up to 5,000 meters
- Maximum Relative Humidity: 100% at up to 54°C (130°F)
- Dustproof / Waterproof (IP66)
- Hazardous Ratings: **Not rated for hazardous locations**
- FCC, CE, Reach, RoHS

WIRELESS SYNCING:

- 2402 - 2480 MHz Bluetooth 4.0 Low Energy
- 13.56 - 13.56 MHz RFID
- Communication Range: up to 100ft (30m) line of sight

DEVICE COMPATIBILITY:

Android

- Bluetooth 4.0 and higher
- Android OS 5.0 and higher

Apple

- iOS 10.0 and higher

DATA STORAGE:

- Data readings every 60 minutes
- Stores 365 days of hourly data points

APP DOWNLOAD:



DC-IL-VG-1 DIMENSIONS

Note: All dimensions are in inches/[mm]

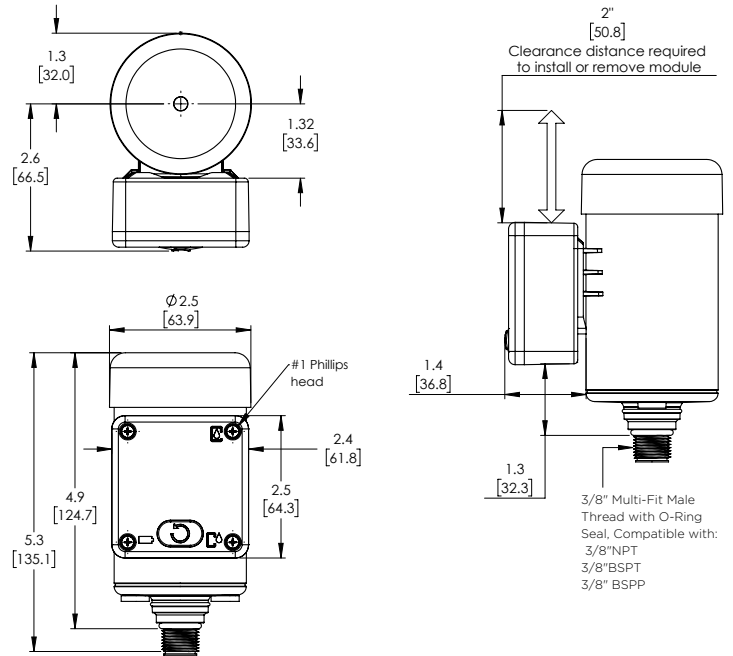

DC-IL-VG-4 DIMENSIONS

Note: All dimensions are in inches/[mm]

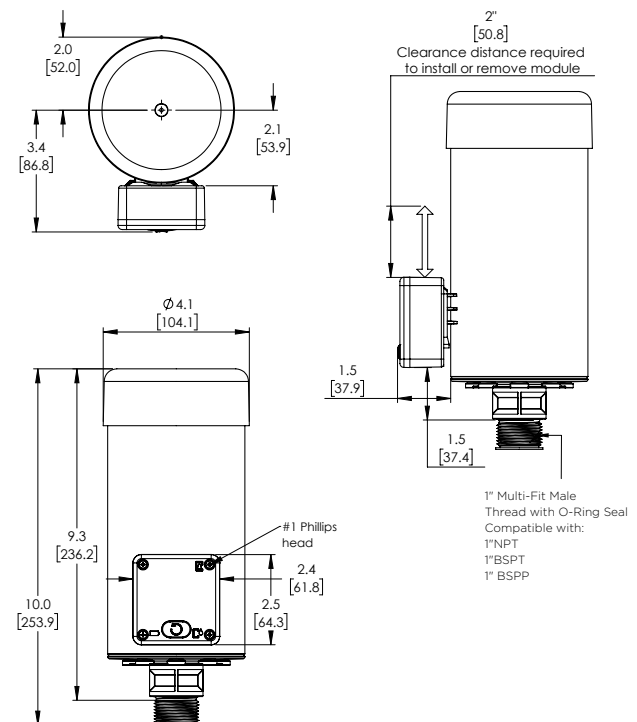

Wired Module

WIRED MODULE MATERIALS & COMPONENTS:

- **Casing:** Polycarbonate, Steel (ball plunger)
- **Cap:** Thermoplastic elastomers (TPE), Steel (screws)
- **Circuit Board:** LED lights, FR4 Fiberglass
- **M8 Connector:** Polyamide 67 GF30, Silicone and Nickel Plated Copper Alloy

WIRED MODULE POWER:

- Supply Voltage: 9-28 V DC
- Operational Current Rating: 30 mA

WIRED MODULE ENVIRONMENT:

- Intended for indoor and outdoor use
- Altitude up to 5,000 meters
- Maximum Relative Humidity: 100% at up to 54°C (129°F)
- Dustproof / Waterproof (IP66)
- Hazardous Ratings: NOT rated for hazardous locations
- FCC, CE, Reach, RoHS

CONNECTIVITY:

- A Coding - M8, 4 Pin Male

DATA OUTPUT:

- **Wireless:** 13.56 MHz RFID (Module & Sensor-board Communication)
- **Serial:** RS485 Half Duplex

DATA STORAGE:

- Data readings every 60 minutes
- Stores 365 days of hourly data points

POWER / DATA CABLE:

- 4 Position Connector with wire leads x 3 m Connected Breather Cable Assembly (sold separately)

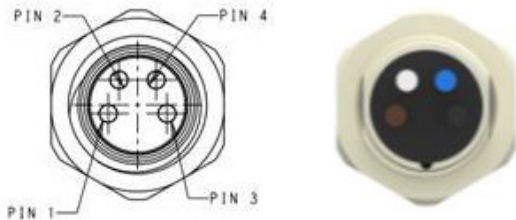

(A Coding – M8, Male 4 Pin)

Pin 1	Brown	9-28V DC
Pin 2	White	TXA (Low)
Pin 3	Black	TXB (High)
Pin 4	Blue	DC Reference
(Mark State)		

DC-IL-M8-VG-1 DIMENSIONS

Note: All dimensions are in inches/[mm]

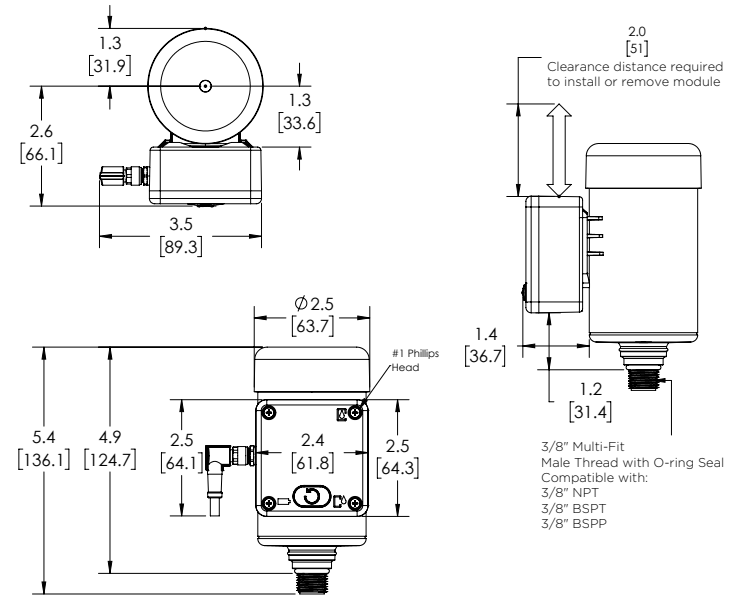

DC-IL-M8-VG-4 DIMENSIONS

Note: All dimensions are in inches/[mm]

